

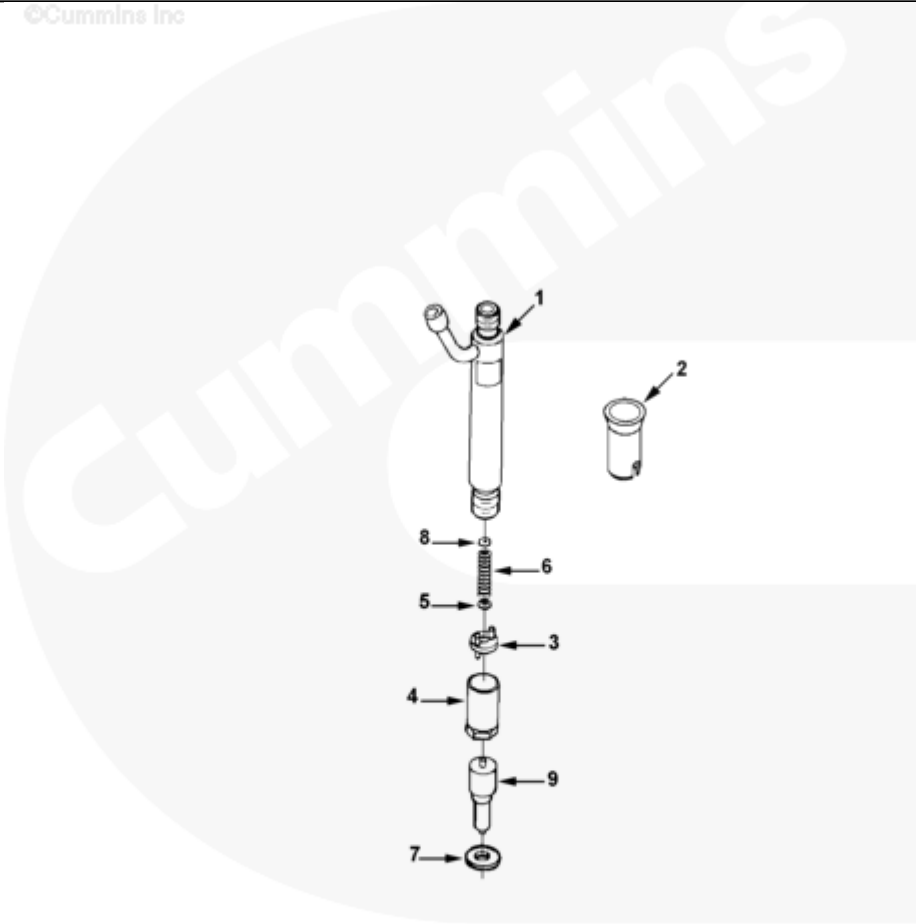

Parts Catalog - Option Detail

Electronic Parts Catalog - Option Detail				
Option	Group	Graphic	Film Card	Date
PP985	06.01.1	fi940ga	Z	20-SEP-96
Engines	6C8.3, C GAS PLUS CM556, G8.3, G8.3 CM558, GTA8.3 CM558, ISC CM2150, ISC CM554, ISC CM850, ISC8.3 CM2250, ISC8.3 G CM2180 C101, ISL CM2150, ISL CM554, ISL CM850, ISL G CM2180, ISL8.9 CM2150 L110, ISL8.9 CM2880 L112, ISL9 CM2150 SN, ISL9 CM2250, ISL9 CM2350 L101, ISL9 CM2350 L111, ISLE4 CM850, L GAS PLUS CM556, L8.9, L8.9 L121, L8.9G CMOH2.0 L125B, L9 CM2350 L116B, L9 CM2350 L119B, L9 CM2350 L120C, L9 CM2350 L123B, L9.3 L105, L9.5 L117, L9N CM2380 L124B, QSC8.3 CM2250, QSC8.3 CM2880 C102, QSC8.3 CM554, QSC8.3 CM850(CM2850), QSL9 CM2250, QSL9 CM2250 L115, QSL9 CM2350 L102, QSL9 CM2350 L107, QSL9 CM2350 L118, QSL9 CM2350 L122, QSL9 CM554, QSL9 CM850(CM2850), QSL9 G CM558, QSL9 M CM2250 L106, QSL9.3 CM2880 L113			



fi940ga

SMALL | MEDIUM | LARGE

Cart	Ref No	Part Number	Part Description	Required	Remarks
View My Cart					
		PP985	Fuel Injector		CPL 985
<input type="checkbox"/>		3802097	Injector	6	Recon Equivalent 3802097 RX
	1	3908507	Injector	1	Bosch
<input type="checkbox"/>	2	3909886	Injector Seal	1	
<input type="checkbox"/>	3	3905154	Intermediate Disc	1	
<input type="checkbox"/>	4	3905155	Injector Nozzle Retainer	1	
<input type="checkbox"/>	5	3915118	Injector Spindle	1	
<input type="checkbox"/>	6	3915119	Compression Spring	1	
<input type="checkbox"/>	7	3906659	Injector Seal	1	For 7mm Head
8					See Below
<input type="checkbox"/>	9	3908508	Injector Nozzle	1	Bosch
<input type="checkbox"/>	8	3905161	Shim	A/R	1.18 mm Thick
<input type="checkbox"/>	8	3905162	Shim	A/R	1.20 mm Thick
<input type="checkbox"/>	8	3905163	Shim	A/R	1.24 mm Thick
<input type="checkbox"/>	8	3905164	Shim	A/R	1.28 mm Thick
<input type="checkbox"/>	8	3905165	Shim	A/R	1.30 mm Thick
<input type="checkbox"/>	8	3905166	Shim	A/R	1.34 mm Thick
<input type="checkbox"/>	8	3905167	Shim	A/R	1.38 mm Thick
<input type="checkbox"/>	8	3905168	Shim	A/R	1.40 mm Thick
<input type="checkbox"/>	8	3905169	Shim	A/R	1.44 mm Thick
<input type="checkbox"/>	8	3905170	Shim	A/R	1.48 mm Thick
<input type="checkbox"/>	8	3905171	Shim	A/R	1.50 mm Thick
<input type="checkbox"/>	8	3905172	Shim	A/R	1.54 mm Thick
<input type="checkbox"/>	8	3905173	Shim	A/R	1.58 mm Thick
<input type="checkbox"/>	8	3905174	Shim	A/R	1.60 mm Thick
<input type="checkbox"/>	8	3905175	Shim	A/R	1.64 mm Thick
<input type="checkbox"/>	8	3905176	Shim	A/R	1.68 mm Thick
<input type="checkbox"/>	8	3905177	Shim	A/R	1.70 mm Thick

<input type="checkbox"/>	8	3905178	Shim	A/R	1.74 mm Thick
<input type="checkbox"/>	8	3905180	Shim	A/R	1.78 mm Thick
<input type="checkbox"/>	8	3905181	Shim	A/R	1.80 mm Thick
<input type="checkbox"/>	8	3905182	Shim	A/R	1.84 mm Thick
<input type="checkbox"/>	8	3905183	Shim	A/R	1.88 mm Thick
<input type="checkbox"/>	8	3905184	Shim	A/R	1.90 mm Thick
<input type="checkbox"/>	8	3905185	Shim	A/R	1.94 mm Thick
<input type="checkbox"/>	8	3905186	Shim	A/R	1.98 mm Thick

© 2019 Cummins Inc., Box 3005, Columbus, IN 47202-3005 U.S.A.
Terms of Use and Disclaimers | Recommended System Requirements
Need Assistance? Please click on the Contact Us button in the top right corner of any page.